



1998 – 2015

[www.ozilboga.com](http://www.ozilboga.com)

[ilbogaticaret@gmail.com](mailto:ilbogaticaret@gmail.com)

# WHO WE ARE?



- Founded in 1998 with the purpose of introducing a new breath to
- construction industry.
  
- Özilboğa Construction and Trade Company is active in the design and production of all kinds of reinforced concrete and steel constructions
  
- There are two facilities in Turkey. İstanbul / Sancaktepe & Düzce.

# QUALITY BORN FROM PROFESSIONALISM...



Özilboğa consist of 2 main units;

- Steel
- Reinforced Concrete

# OUR FACILITIES



## Sancaktepe / İstanbul

<b>Closed Facilities</b>	<b>10.000 m2</b>
<b>Open Facilities</b>	<b>12.000 m2</b>
<b>Office Area</b>	<b>350 m2</b>
<b>Capacity of Factory</b>	<b>200 Ton/Month</b>
<b>The number of white – collar staff:</b>	<b>25</b>
<b>The number of blue – collar staff:</b>	<b>52</b>
<b>The number of subcontractor Employee:</b>	<b>50</b>
<b>TOTAL</b>	<b>127</b>



## Düzce

<b>Closed Facilities</b>	<b>12.000 m2</b>
<b>Open Facilities</b>	<b>7.200 m2</b>
<b>Offices Area</b>	<b>800 m2</b>
<b>Capacity of Factory</b>	<b>1.200 Ton/Month</b>
<b>The number of white – collar staff:</b>	<b>20</b>
<b>The number of blue – collar staff:</b>	<b>109</b>
<b>The number of subcontractor Employee:</b>	<b>57</b>
<b>TOTAL</b>	<b>186</b>



# DÜZCE FACTORY



# DÜZCE FACTORY EQUIPMENT POOL

Equipment	Pcs	Features
H profile line up to HEA 1500, Profile reconstructed & welding & rectification	2	(Centring, Submerged, Rectification)
Sandblasting infinite (Automatic sandblasting with 8 tribune)	1	2700x800
Plasma Machine CNC – 4 Axis(Pipe & Sheet)	1	3000x12000x65
Plasma Machine CNC – 5 Axis(Pipe & Sheet)	1	3000x12000x65
Cutting Machine with Flame	1	5000 x 18000
3 Gantry Crane (10 Tons), 12 Ceiling Crane (3 Pcs, 5 Tons & 10 Pcs 10 Tons)	15	
Magnetic Hole Drilling	3	
Drilling Machine (CNC – 3 Axis)	2	H 1200 & H 1000
Radial Hole Drilling – 50 mm & 32 mm	3	

# DÜZCE FACTORY EQUIPMENT POOL

Equipment	Pcs	Features
Profile Bending Machine	3	
1000B & DC 1000 submerged arc welding	9	
Lincoln Gas Metal Arc Welding	59	500 Amp
Fully Automatic Bandsaw	5	

# DÜZCE FACTORY – SANDBLASTING



# DÜZCE FACTORY – CNC COUNTER



# DÜZCE FACTORY – DRILLING MACHINE





# DÜZCE FACTORY – GANTRY CRANE



# DÜZCE FACTORY – GENERAL VIEW





# MANUFACTURING PICTURE



# MANUFACTURING OF ELECTRIC TOWERS



# MANUFACTURING OF ELECTRIC TOWERS





# MANUFACTURING OF ELECTRIC TOWERS



# DÜZCE FACTORY – FUNCTIONAL LAYOUT

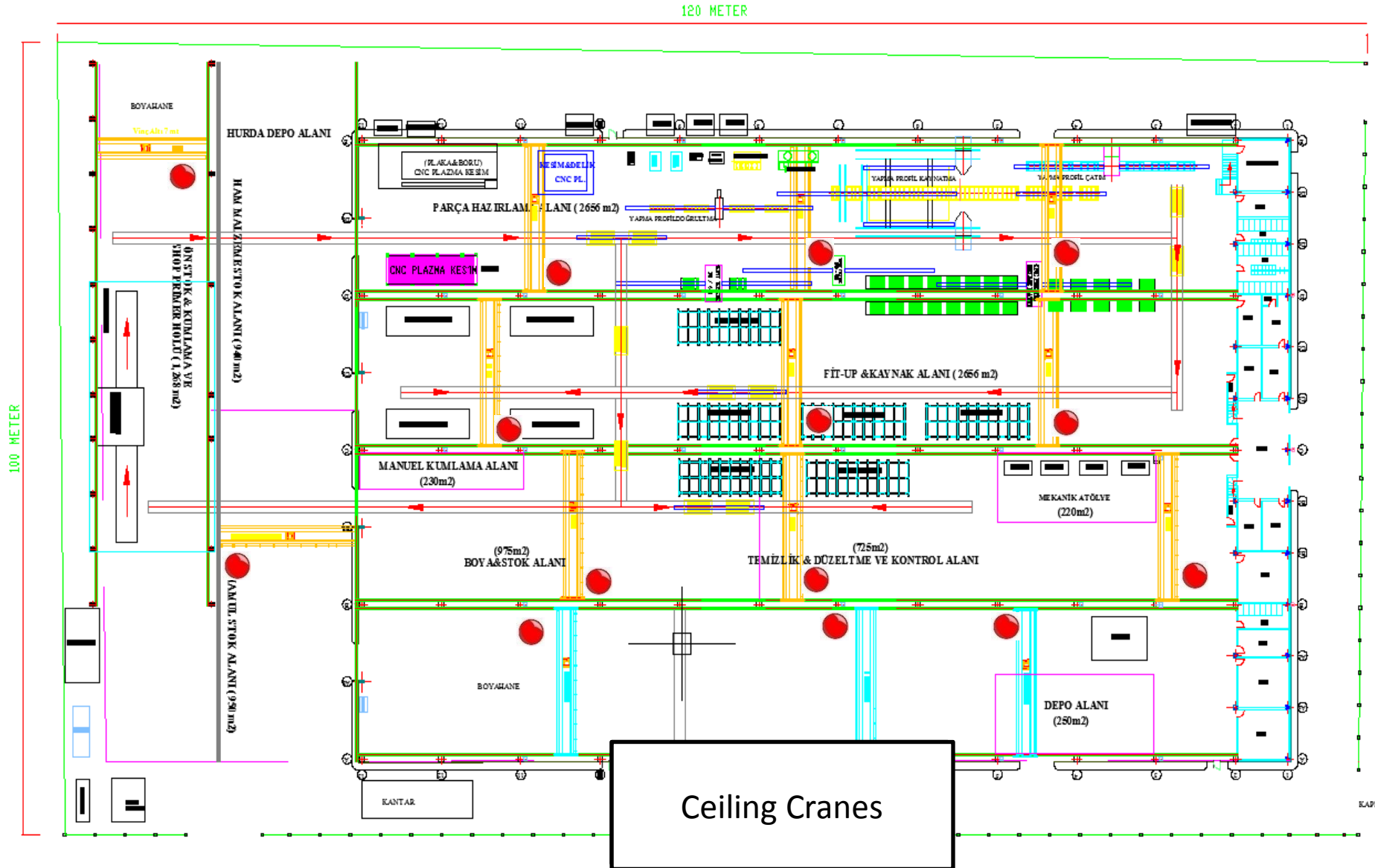

# SANCAKTEPE FACTORY - HEAVY STEEL EQUIPMENT POOL



Equipment	Pcs	Features
Sandblasting Machine	1	length up to2700x800
Automatic Painting	1	-
Plasma 3000x12000x65 section CNC	1	3000x12000x65
Gas Metal Arc Welding Machines	20	-
Saw (1000 and 1400 mm)	1	-
Bending Machine	1	(3110 mm can twist up)
Fully Automatic Bandsaw	1	Graph straight and angle cutting equipment)
2 Gantry Crane ( 10 Tons & 5 Tons)		
4 Ceiling Crane ( 5 Tons & 10 Tons - 3 Pcs)		

# SANCAKTEPE FACTORY- H-PROFILE LINE





# SANCAKTEPE FACTORY – GENERAL VIEW





# SANCAKTEPE FACTORY – AUTOMATIC BANDSAW



# SANCAKTEPE FACTORY- SANDBLASTING



# SANCAKTEPE FACTORY – FUNCTIONAL LAYOUT

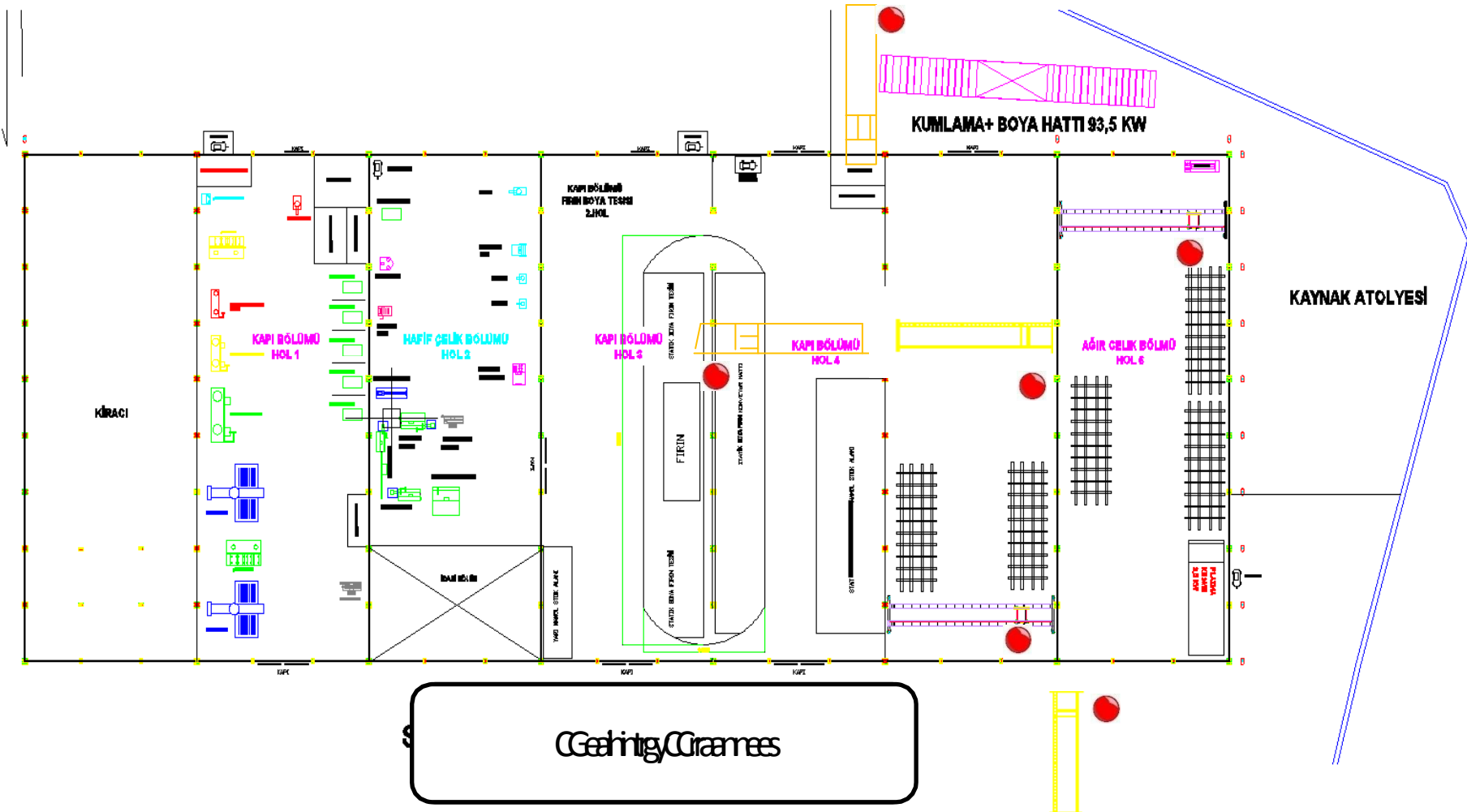



# CERTIFICATES



## •INSULATION



## •FIRE RESISTANT



## •FIRE RESISTANT -2



## TEST REPORTS

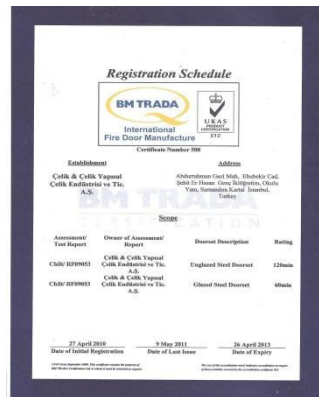

## •Q – MARK CERTIFICATES



# PROJECTS







KERBALA STADIUM - IRAQ



KERBALA STADIUM - IRAQ





ERBIL SPORTIVE COMPLEX - IRAQ



SERANİT – TILE MANUFACTURING PLANT/ESKİŞEHİR



ISTANBUL TECHNICAL UNIVERCITY – 550 TONS / ISTANBUL





SİNPAŞ – ALTINORAN / ANKARA



DYSK METAL - ÇORLU (POSCO & DAI YANG COOPERATION) /2.500 TONS



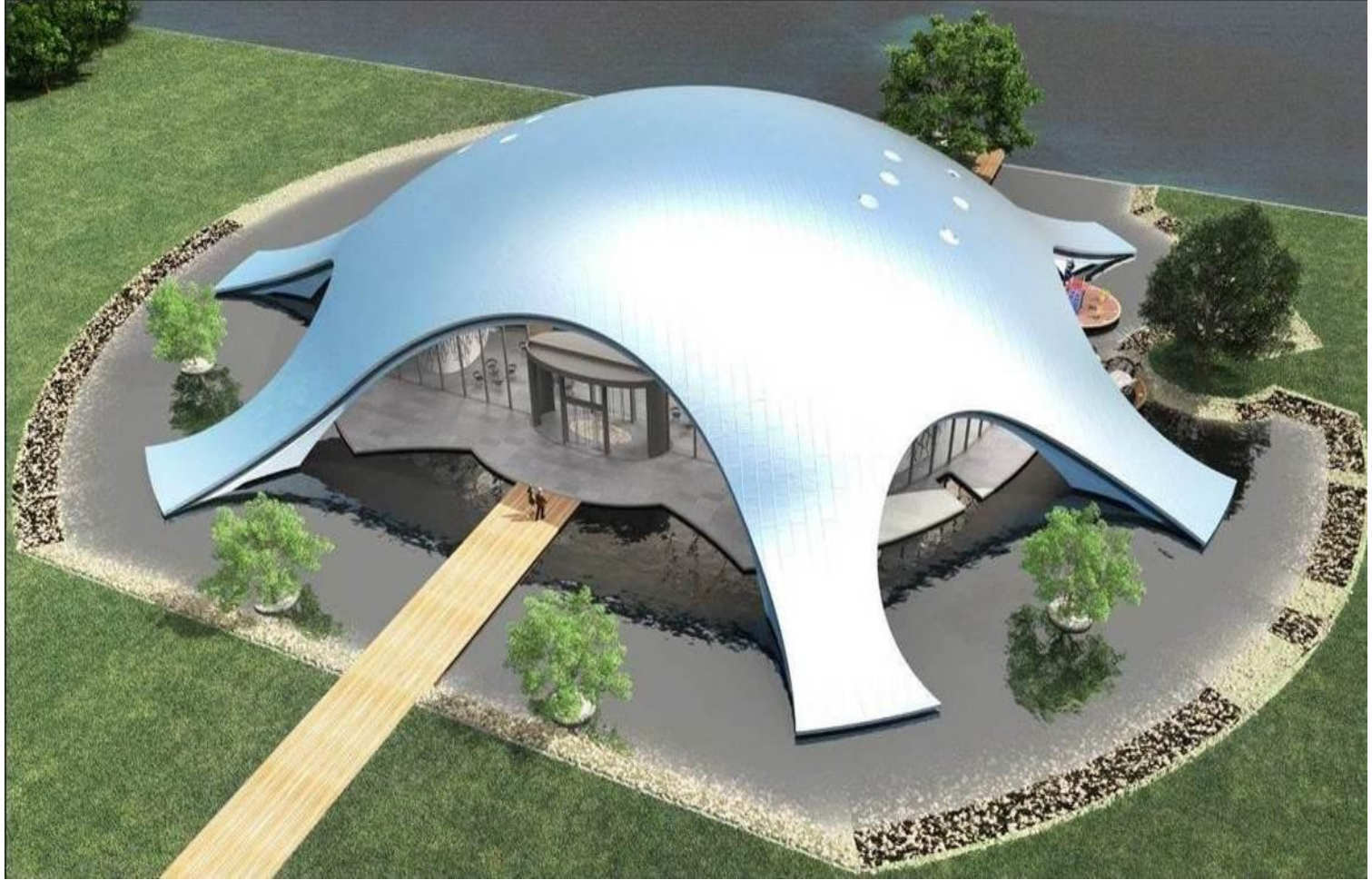

KAT GYO – SALES OFFICE/ İSTANBUL



ISTANBUL TECHNICAL UNIVERCITY – TEKNOKENT/ İSTANBUL





KELEBEKİA - SOCIAL FACILITIES





SINPAS FLAT OFFICE/ İSTANBUL



SİNPAŞ HEADQUARTERS





HAKAN ŞÜKÜR STADIUM - ISTANBUL





















